

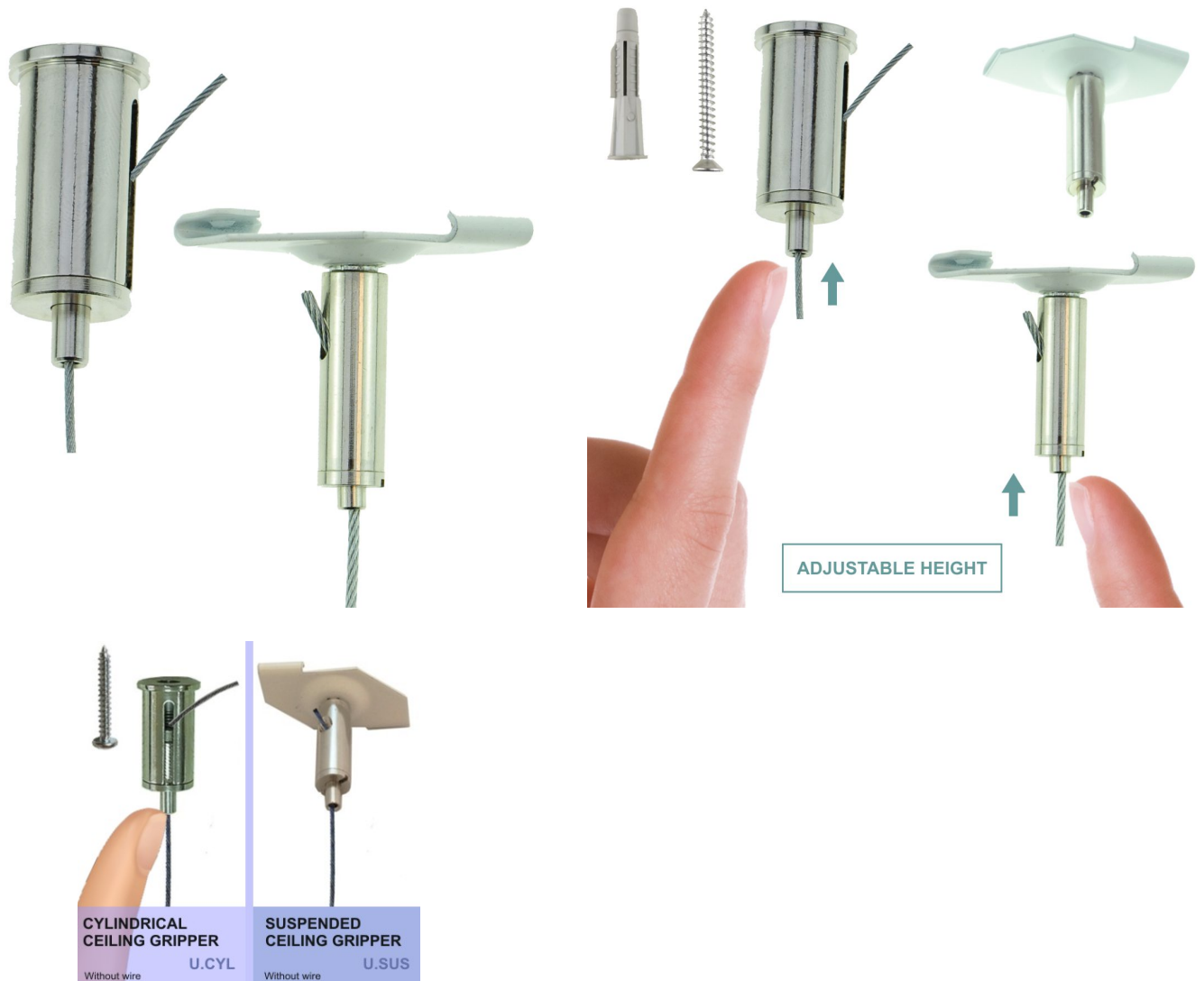

Ceiling fixings with height adjustment

Short Description

- Wire ceiling anchors with cable height adjustment for plasterboard or suspended ceilings
- In-built cable gripper with push button clutch release makes height adjustment a breeze
- Suitable fixing for suspending sneeze screens when you already have the wires



Description

Wire rope ceiling fixings with cable height adjustment

Ceiling fixings to attach wires to ceilings with in-built height adjustment automatic locking system. Two versions are available, either for attaching to conventional plasterboard using a screw and plastic plug, or for locking onto the grids of standard suspended ceilings.

For use with 1.5mm wire rope (available separately) these fixings attach to the ceiling and accept a plain end cable which may have a hook or loop attachment on the bottom end. Please note that these fittings are sold individually, not in pairs.

Screw-on cylindrical ceiling gripper (U.CYL)

Chrome screw-on Cylinder Gripper without wire rope. The fitting comes apart so the outer casing can be screwed to the ceiling. Each cylindrical gripper is supplied with a screw and plastic plug.

TIP: For heavier loads (e.g. between 2kg and 15kg) the supplied plastic plug can be replaced by a higher rated plasterboard plug such as Fischer DuoPower 6x30.

Suspended ceiling gripper (U.SUS)

Chrome twister suspended ceiling grid gripper without wire rope. The specially shaped white metal base-plate attaches securely to standard 1" ceiling grids with twist action.

LOADING: Our fitting is suitable for loads up to 15kg when paired with 7x7 construction 1.5mm diameter wire rope. However ceiling grids are not generally intended for additional loads of this magnitude. The maximum load is likely to be limited by the ceiling design.

Excess Cable:

In both cases, excess cable protrudes through a slot in the side of the casing – it can be rolled up, if subsequent adjustment is envisaged, or trimmed off using wire cutters.

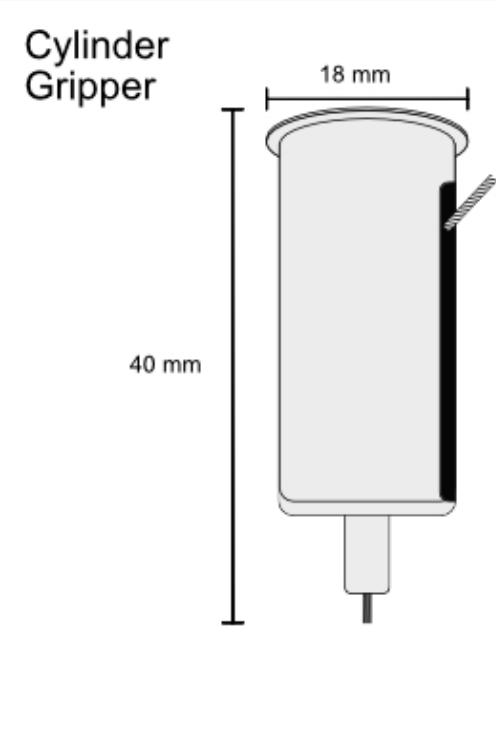
More Information	<p>These components allow for adjustment of the hanging wire at the ceiling. They are ideal for use when length adjustment facility does not exist at the lower end of the wire.</p> <p>Alternative fittings offer a fixed (non adjustable) attachment point for hanging wire ropes and cables. Such fittings may be used when the lower end of the wire comprises an adjustable height hook or fitting. Generally there is no point in providing height adjustment at both the top and bottom of the drop wire.</p> <p>The cable or drop wire can be shortened back simply by pulling more cable through the wire exit port in the respective fitting. To drop the cable (i.e. to lengthen) simply depress the spring loaded button where the wire enters the fitting to release the cable clutch. After final adjustment any excess cable can be snipped off using good quality wire cutters.</p>
Product Dimensions	 <p>The diagram shows a cylindrical component labeled 'Cylinder Gripper'. It has a diameter of 18 mm and a height of 40 mm. A vertical line on the right side indicates the height, and a horizontal line at the top indicates the diameter. A small detail on the right side shows a cross-section of the cylinder with a hatched area representing the internal structure.</p>
Delivery and Returns	<ul style="list-style-type: none">• We offer a choice of delivery options tailored to the goods selected and your location, calculated for you automatically in the Checkout. When feasible, you will be offered options for Free, Economy or Next Day delivery.• Any product returned by the purchaser must be unused and in its original packaging, which should be unmarked. If goods are received damaged or faulty we will take care of the problem.• For detailed information about Delivery charges or Returns and refund policies, please click on the links below.
Include in Google Feed	Yes
Postable	No

Small parcel	No
Oversize	No

