



Black poster display cases

Short Description

- Black lockable poster cases are smart, practical and great value
- Weatherproof outdoor or indoor use with hinged locking door
- Ideal for wall mounting - for displaying single posters or notices
- * Free delivery on orders over £100 (ex VAT)

Product Images



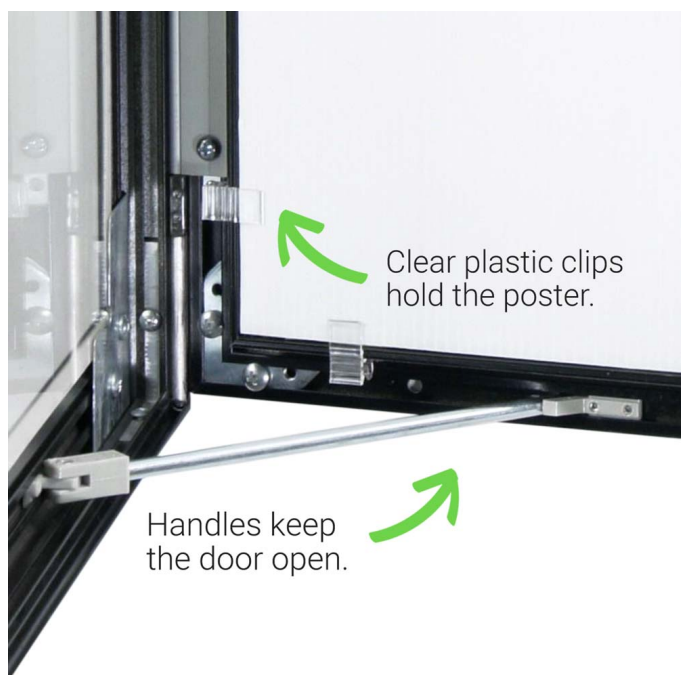

Description

Black Lockable Poster Cases

Our **black poster case**, aka **black menu case** range is designed to display a poster or menu behind glazing in a robust black metal frame, with a hinged door secured by a lock. The smart black powder coat finish is a durable paint process for long-lasting good looks.

Black Menu Case

Compared with most [black poster frames](#), our black poster cases offer the advantage of a more substantial surround with a hinged locking door to prevent tampering. Additionally our black menu case range benefits from being weatherproof, and hence suitable for outdoor locations. The display case is primarily designed for a single poster or menu (as opposed to multiple sheets).

Waterproof Postercase

Our black lockable poster display cases are waterproof and intended for wall mounting outdoors, as well as for internal poster displays.

The larger sizes, including black A1 poster case and black 30x40 cinema poster case, are Premium models (designated by PREM suffix) with a rubber gasket seal. They are supplied with twin locks.

Features and Benefits

- Black lockable poster cases are stocked in all popular poster sizes from A4 up to 30x40 inch.
- Hinged door black menu display case for posters in smart black finish with tough clear polycarbonate glazing.
- The door is fitted with a lock and supplied with a pair of keys (additional keys are available).
- Posters are held in place with clear plastic clips around the perimeter of the frame - clips are hidden when the door is closed.

- The frame size is defined by the size of poster it will fit, from A4 and A3 up to A2, A1 and 30x40 inch. See more details.
- The frame is waterproof enabling outdoor use in most situations.
- The black poster display case can be fitted portrait or landscape – in which case the built-in door stays help to hold the door open during poster changes.
- Poster display case is easily screwed to a wall or a backboard (fixings included).

More Information

Black poster case is perfect for the display of a single poster

- Black poster cases are mainly intended to display a poster matched to the size of the case - the poster is secured by plastic clips concealed behind the rim of the door.
- As well as displaying posters printed on paper the display case will accept thicker card and other flexible substrates up to 1.5mm thick.

If you wish to use a Poster Case as a notice board (e.g. for multiple A4 sheets rather than a single poster) the individual notices will need to be secured to the back panel by sticky dots or Blu Tack. There isn't sufficient space behind the door for pin heads and moreover the backing board is not designed to accept pins or thumb tacks.

Condensation

Condensation on the inside of the door can occur under certain atmospheric conditions. It is the same situation as inside a car windscreen where condensation can occur without implying that rain has actually entered.

Typically on a cold night after a humid day the water vapour in the air can condense on any cold surface (such as the glazed door or car windscreen) and this is unavoidable. In most situations any misting clears of its own accord as the glass (or clear plastic) warms up again.

Product Dimensions

Key things to consider.

- The viewable area will be smaller than the physical poster size by 20mm all round.
- Maximum thickness of poster must be no more than 1.5mm.
- The frame width is 45mm (viewed from the front).
- The depth (thickness) of the postercase is 30mm.

Product Code	Poster Size	Copy Size	External Size
LPC.A4-B	210x297mm	190x277mm	280x367mm
LPC.A3-B	297x420mm	277x400mm	367x490mm
LPC.A2-B	420x594mm	400x574mm	490x664mm
LPC.20.30-B	508x762mm	488x762mm	578x832mm
LPC.A1-B	594x841mm	574x821mm	664x910mm
LPC.30.40-B	762x1016mm	742x996mm	832x1086mm
LPC.A0-B	841x1189mm	821x1069mm	911x1259mm

Diagram 1: Side View

Wall

30 mm

Ext. Width

Ext. Height

Key

45 mm

Copy Area

Diagram 2: Top View

(external size)

(poster size)

(Copy Area)

Diagram 3: Cross-section

PET-G

Poster

Propopylen (Correx)

45 mm

30 mm

Delivery and Returns

- We offer a choice of delivery options tailored to the goods selected and your location, calculated for you automatically in the Checkout. When feasible, you will be offered options for Free, Economy or Next Day delivery.
- Any product returned by the purchaser must be unused and in its original packaging, which should be unmarked. If goods are received damaged or faulty we will take care of the problem.
- For detailed information about Delivery charges or Returns and refund policies, please click on the links below.

Include in Google Feed

Yes

Postable

No

Small parcel

No

Oversize

No

