



Lockable Poster Case - Double Royal poster size

Short Description

- Lockable poster case for double royal paper size
- Perfect for sheltered outside spaces and large indoor spaces
- Can be mounted in portrait or landscape

Product Images



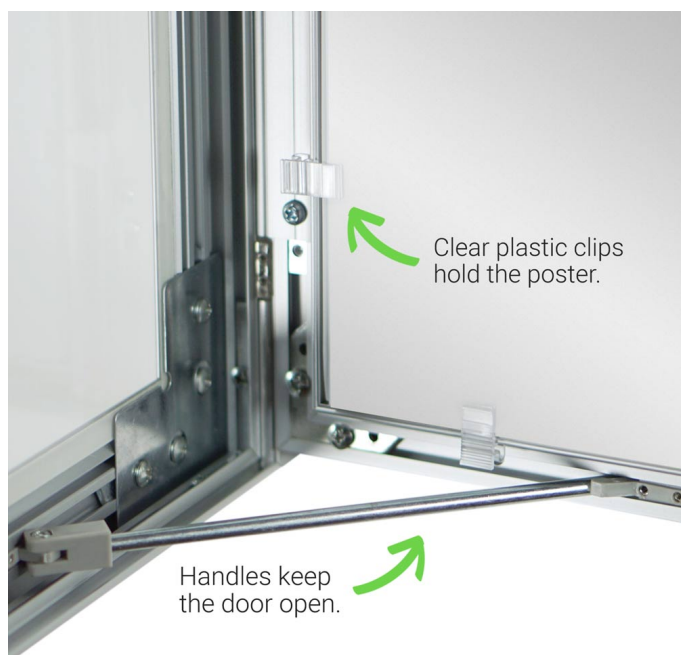

Description

Double Royal paper size poster case

This double royal paper size poster case is part of our range designed specifically for the rail industry, where double royal size is standard. This substantial lockable poster case is perfect for an entrance, ticket office and platform communications and advertising. Designed to create impact and be seen from afar or whilst on the move, the double royal lockable poster case is also attractive in large public spaces such as retail outlets and entertainment venues or attractions.

- Double royal paper size is 40 inches x 25 inches wide (1016mm x 635mm)
- Designed for railway and transport hub information display
- For indoor or sheltered outside use
- Robust design - shatter-resistant glaze and rust-proof aluminium frame
- Fitted with a twin lock and is supplied with two keys
- Supplied pre-drilled with fixing holders, wall plugs and screws for hassle-free fitting
- Mount in landscape or portrait

The sample stock held in our UK warehouse is anodised silver, however, powder coating in any standard RAL colour (which adds an extra durable painted coating) is available for a minimum order of 30 units.

Can lockable poster cases suffer from Condensation?

For the best long-term outdoor results, ask your print partners to use 180-micron Polyprop waterproof paper and waterproof inks.

Condensation on the inside of the door can occur under certain atmospheric conditions. It is the same situation as inside a car windscreen where condensation can occur without implying that rain has actually entered.

Typically on a cold night after a humid day the water vapour in the air can condense on any cold surface (such as the glazed door or car windscreen) and this is unavoidable. In most situations, any misting clears of its own accord as the glass (or clear plastic) warms up again.

Double Royal lockable poster case

More Information

The double royal lockable poster case has been designed as part of a range of products aimed at the transport industry, where being seen from a distance and/or whilst on the move is a particular issue.

This is a sizeable and robust poster case incorporating an aluminium frame which is water-resistant to negate rusting and has a shatter-resistant rigid polycarbonate glazed hinged door with good outdoor weathering characteristics. The back wall is white twinwall rigid plastic.

Product Dimensions

- Double royal poster size = 1016mm x 635mm (40 inches high x 25 inches wide)
- Frame depth = 30mm front to back
- Frame width = 45mm viewed from front

Assembly and Installation

Fixings supplied: wall plugs, screws
Frame is pre-drilled for easy placement and mounting

Delivery and Returns

- We offer a choice of delivery options tailored to the goods selected and your location, calculated for you automatically in the Checkout. When feasible, you will be offered options for Free, Economy or Next Day delivery.

- Any product returned by the purchaser must be unused and in its original packaging, which should be unmarked. If goods are received damaged or faulty we will take care of the problem.

- For detailed information about Delivery charges or Returns and refund policies, please click on the links below.

Include in Google Feed

No

Postable

No

Small parcel

No

Oversize

No

